

## The Beacon

The Beacon is a large house situated between Beacon Road and Beacon Lane and has been owned at times by some of the most influential residents of Kingswear. There is a lighthouse, or beacon, a short distance away acting as a leading light to the entrance of Dartmouth Harbour and probably accounts for the name of the roads and the house.



**Figure 1 Modern day photograph of The Beacon**

The above photograph shows the present Beacon house. The tower on the right is the foundation of the 1864 navigation beacon, now reconstructed on a rock further down the beach.

Figure 2 shows a panoramic view contained in an Admiralty chart of Dartmouth Harbour dating from 1853 but with corrections up to 1880. It shows both a lighthouse and a separate mast light immediately below the house.

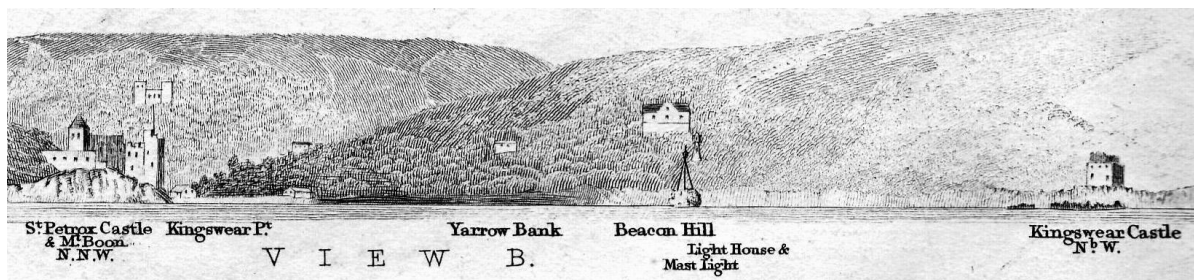
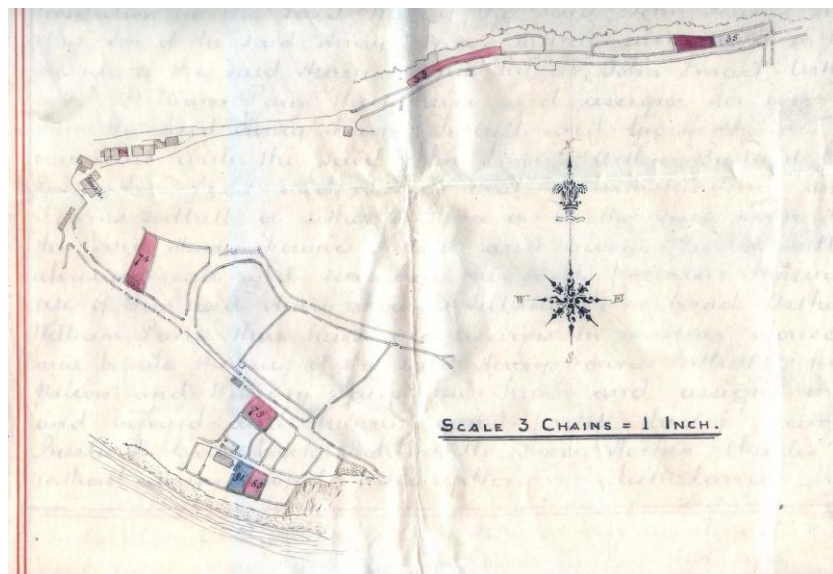

**Figure 2 Depiction of Beacon House on an Admiralty chart dating from 1853**

Governor Holdsworth bought the land in 1845 and built the house shortly after. Arthur Howe Holdsworth was a Member of Parliament and Governor of Kingswear Castle and a very influential person in the area. He lived in The Beacon until 1857 when he moved back to his family home at Stokenham where he died in 1860.

In November 1855 the Dartmouth Chronicle recorded the death of a Capt Justice R.N. aged 63, at The Beacon and in June 1858 the house was put up for sale to be bought by Mr T Lovett-Prinsep who was to become another local worthy. The 1861 census records two servants also living there, Mary Salter aged 47 and Emma Martin aged 16. In the June 1861 edition of the Dartmouth Chronicle reported that the Beacon had been let to Miss Domville. The entry continues *that numerous enquiries for detached houses having communication with the river side have been made, and it is to be regretted that no efforts are made to supply the great want of residences of this description.*

An indenture dated 29 May 1867 records the sale and transfer of some nearby land by the trustees of Church Lands Property. The map accompanying the sale is shown in figure 3. The trustees associated with the sale included the Rev John Smart, the “perpetual curate of Kingswear”; Arthur Bastard Eastabrooke Holdsworth (son and heir of Governor Holdsworth), whose address was recorded as Widdicombe House in Stokenham, Percy Hockin of Dartmouth, Charles Nelson of Kingswear and William Paige of Hoodown then in the parish of Brixham. The recipients were Henry Fownes Lutterell of Dunster Castle in Somerset and George Fownes Lutterell of Woodlands also in Somerset. The sale involved the transfer of the sites shown red in figure 3 in exchange for £322. In addition the Lutterells would transfer to Percy Hockin the area of land coloured blue. Percy Hockin was a local Dartmouth solicitor who, in the Post Office Directory of 1861, is listed as living at Nethway. He was also chairman of the Kingswear Parish Meeting and it was his task, following the Local Government Act of 1894, to call the first Kingswear Parish Council Meeting for the 7<sup>th</sup> January 1895.



**Figure 3 Land sold or exchanged on 29 May 1867**



The Tithe Commutation Act of 1838 resulted in the detailed mapping of Kingswear in 1840 in which each plot of land was numbered. Part of the Tithe Map is shown later in this paper in Figure 7. For many years the tithe map of Kingswear provided a convenient way of identifying plots of land when buying and selling. In the case of the above indenture the land transferred to the Lutterells at the site of The Beacon is numbered 79 and 85. That land passed to Mr Hockin is number 91.

Three days later, on the 1<sup>st</sup> June 1867 there was another indenture in which the two Lutterells sold land to Theophilus Levett of Bovey Tracy and Caroline Mary Levett-Prinsep of The Beacon, Kingswear for £2000. The land involved in this sale include the sites 79 and 85 on the sale to the Lutterells three days earlier as well as three other sites, 87, 88 and 89 already owned by the Lutterells. These are shown in red and blue respectively on the sale plan – figure 4. Included in the indenture was the transfer of the plot 75, uncoloured in figure 4, to the Lutterells. This latter plot was included in the Lutterell sale of 1874.



**Figure 4 Sale map of 1 June 1867**

There is a memorial plaque made of Ashburton marble in Kingswear Church to Caroline Levett-Prinsep, see figure 6, and shows that she died later the same year. Mrs Levett-Prinsep was the sister of James Temple who in 1792 built Stover House (now a preparatory school), the Stover Canal and the Haytor Granite Railway which brought granite from Dartmoor for the building of London Bridge and the Houses of Parliament

Another sale is recorded on the 15<sup>th</sup> April 1869. This time a Charles Henry Roope, of Moorgate Street in the City of London, sold plot 93 to Thomas Levett-Prinsep of The Beacon. Charles Roope was the son and heir of Roope Harris Roope late of Kingswear. The location of plot 93 can be seen in figure 4 to the right of plots 79 and 88 and extends the full way between the two roads. Although other houses are shown on the maps, including the one accompanying the 1869 sale, the location of The Beacon is not shown.

Of the same date as the above a Deed Poll is recorded with the accompanying map shown in figure 5. The reason for the Deed Poll, by Thomas Levett-Prinsep, Esq., is not clear as its only statement is "to enlarge a term of Five Thousand years in Lower Foxhole Garden, Kingswear, Devon, into a fee simple".

A year after the death of Caroline, Thomas married Georgina Holdsworth, a member of the family which originally built The Beacon. The same year the Dartmouth Chronicle records a sad occasion on the 19<sup>th</sup> April 1869 premature birth of a daughter, Margarita, who died two days later.

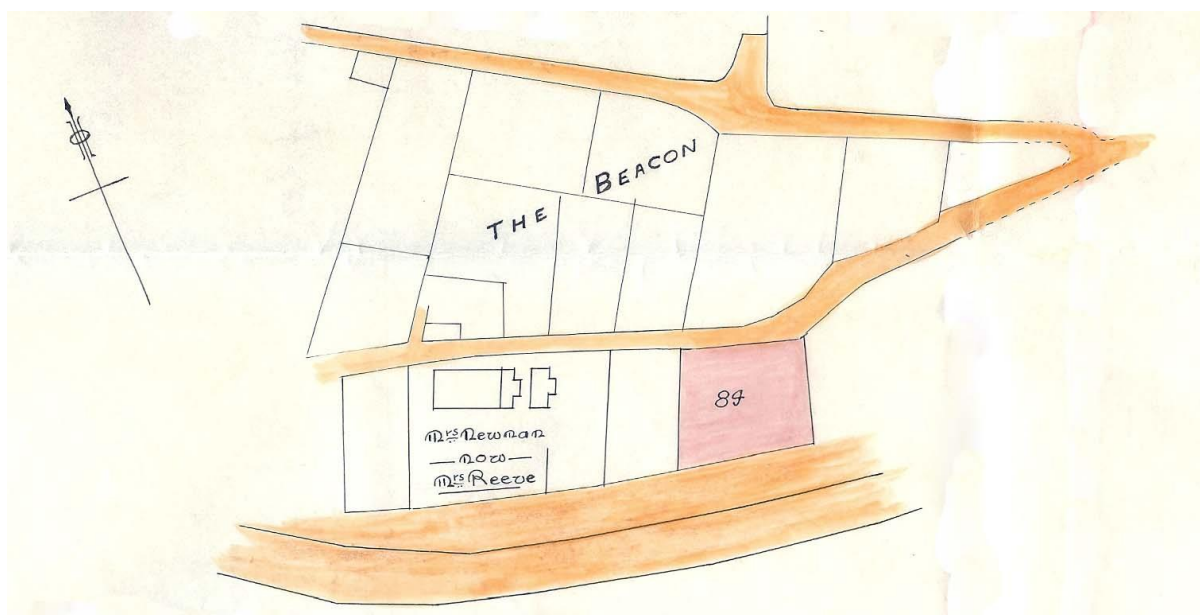

**Figure 5 Map accompanying the 1869 Deed Poll**

The Levett-Prinseps moved back to their estate at Croxall Hall in Derbyshire and in April 1871 the Dartmouth Chronicle reported that:

*The delightful residence known as The Beacon has been taken by G.F Freke for a term of 7 years*

and in June 1872 a son was born to Mrs at the Beacon.

In July 1877 the Levett-Prinseps returned and had another daughter born at house.

In July 1880 the Chronicle reported that, whilst on a visit to Kingswear, the Rev F Fenwick Reevely, of West Lexham Rectory, was nominated by the Crown for the living of Kingswear, vacant by the death of the Rev John Smart. It stated that earlier Mr Reevely had married Miss Domville whose family owned the Beacon, previous to its purchase by Mrs Prinsep. For some reason Mr Reevely did not take up his post, or not for very long, as the new vicar was in fact a Rev Frederick Walker, late curate of Longeaton in Derbyshire.

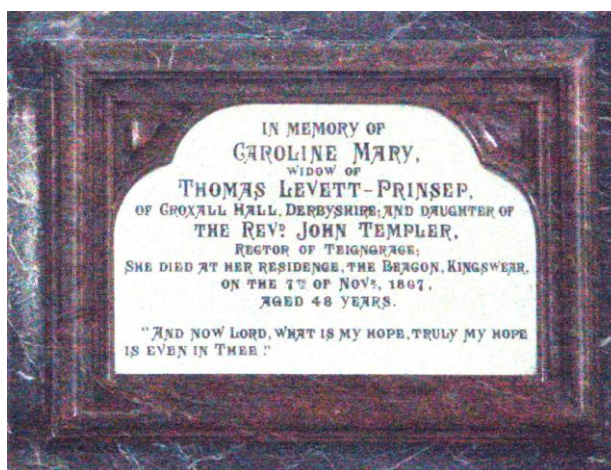

**Figure 6 Memorial to Caroline Levett-Prinsep**

In 1881 there was another census and the inhabitants of The Beacon are listed as:

John B Hayes, 32, born in Arborfield, Berkshire and lately captain 12<sup>th</sup> Royal Lancers.  
His wife Julia A, 32, born at Clapham.

Their two daughters Annie E aged 1 year and Lucy J aged 10 months both born in London.

Nurse Ellen Evans, 28, born in Exeter.

Parlour maid Annie Colper, 22, born in Wexford, Ireland.

Cook Elizabeth Jurney born in Ross, Herefordshire.

In April 1883 the Chronicle reported that Capt Hayes had bought The Beacon from Mr Levett Prinsep. Then in February 1884 that he had

*offered his fine iron steam yacht Lancer to the Government for service in Egypt.*

However in November 1884 the Chronicle reported his death from pneumonia. The obituary records

*the decease of Capt. Hayes late the 12<sup>th</sup> lancers at the early age of 35. Capt. Hayes about three years since purchased of T.L. Prinsep Esq. the charming residence known as the Beacon, which he enlarged and considerably improved. The deceased was an enthusiastic yachtsman and by his courtesy was a general favourite. He leaves a wife and a family of three daughters. The remains will be interred at Aborfield near Reading, the seat of his father, the Rev Sir John Hayes Bart. The body will leave the house tomorrow at 8 o'clock enclosed in three coffins the outside being of polished oak with brass mountings and breastplate and the funeral arrangements are under the management of Messrs T.S. Lovell and Son, Duke Street.*

The Dartmouth Chronicle of 6th August 1886 reports an

*INTERESTING FIND – The Gardener at the Beacon, Kingswear, when digging last week, discovered a most interesting coin of the second century. It is inscribed "V. T. Commodius," who by reference to Gibbon, reigned in A. D. 180. On the reverse a spread Eagle. This establishes the fact that the Romans must have had some connection with Kingswear about the above named date.*

Who owned The Beacon at this time is not clear but in July 1887 it is reported that

*The tender by Mr F Matthews, builder, St Marychurch has been accepted, for the additions to be carried out at the Beacon, the residence of Lieut-Colonel Daubeny. The additions include an entrance hall 14ft by 13ft; dining room 36ft. by 18ft; two bedrooms, bath room, lavatory, etc. Mr H Winsor of Dartmouth and Mr H Matthews of Paignton were next lowest competitors. The additions being from plans of Mr E Appleton of Kingswear and Torquay.*

Mr Edward Appleton was also the architect overseeing the rebuilding of the Kingswear Church, St Thomas of Canterbury in 1845.

There is a settlement, dated 19<sup>th</sup> October 1892, made between H W Popham, George William Culme Soltau-Symons, Constance Lina Soltau-Symons, George Algernon James Soltau-Symons, Charles Bewes Cecil Harcourt Wingfield Popham and Herbert Blaney Wade. The relevance is not clear although Mr Popham was to become a future owner.

A "Fashionable Wedding at Kingswear" is reported on the 20th April 1894 between Comm. Henry Peter Ronth R.N. and Ethel Blanche, third daughter of Lieut-Col and Mrs Daubeny. The service being conducted by the Revs Elton Lee and F Walker. There was another marriage, of their eldest daughter to Lieut Robert Benson. This time the Rev Walker was assisted by Rev J.H. Berry R.N. who was chaplain to the naval barrack at Stonehouse.

The 1891 Census lists the residents of The Beacon as:

John Daubeny aged 49 living on own means and born in Cheltenham,  
Wife Eliza 42 born in South Wales,  
Daughter Mary 19 born in Dover,  
Her sister Ethel 18 born in Cleeve, Somerset,  
John Daubeny's brother Frederick 32

In 1897 the remaining daughter, Margaret, married Robert Ross Benson (later Vice-Admiral Benson). They had one son. Mrs Benson died in 1924 and The Times reported the death of Vice Admiral Benson on 4th Feb 1927.

On the 11th August 1904 there was a conveyance between Llewellyn Llewellyn and Evan Henry Llewellyn, St. John Edward Daubeney and Home William Popham and on the same date a mortgage was taken out in the names of Home William Popham, George Algernon James Soltau-Symons, Charles Bewes and Cecil Harcourt Wingfield Popham.

Little seems to have been recorded for the next thirty years although in the parish council minutes for 1905 there is a report of nude bathing on Lighthouse Beach, part of The Beacon estate, and the police constable was asked to catch those responsible so that they could be prosecuted.

Then on the 25th April 1935 the Paignton Western Guardian reported that

*The death took place of Mr Home William Popham at the Beacon aged 67 years. He got up in the morning and had breakfast apparently in good health, about mid-day he had collapsed and passed away. The deceased sat on the Brixham Bench. He was also a member of the R.D.Y.C. whose flag was flown at half mast. He had resided in Kingswear for 40 years. He attended church regularly and always read lessons at festivals.*

It would appear that upon Mr Popham's death the property was placed in a trust. A conveyance, dated 27<sup>th</sup> April 1945, records the sale of The Beacon by the National Provincial Bank Limited of London, Frances Russell Benedict Simpson, a clerk in Holy Orders of Maypool in Galmpton and Cicely Anne Waterson of Alton in Churston Ferrers. The buyer was Elizabeth Gwladys Bankart of Eastney in Kingswear and the price £7400.

This conveyance refers to an earlier one of the 1<sup>st</sup> September 1938 "made between Constance Lina Popham of the first part, Betty Adela Kate Popham of the second part, George Algernon James Soltau-Symons and Charles Bewes of the third part and the Vendors of the fourth part". The vendors being those listed in the above paragraph. The sale was "In fee simple upon trust to sell the same but so that during the joint lives of the said Constance Lina Popham and Betty Adela Kate Popham and the life of the survivor of them every sale should be made only with their or her consent in writing".

This explains another matter. The parish council had long maintained the area known as Lighthouse Beach and the footpath over land leading to it from Beacon Lane. The council were on very good terms with Mrs Popham and were convinced that upon her death she would

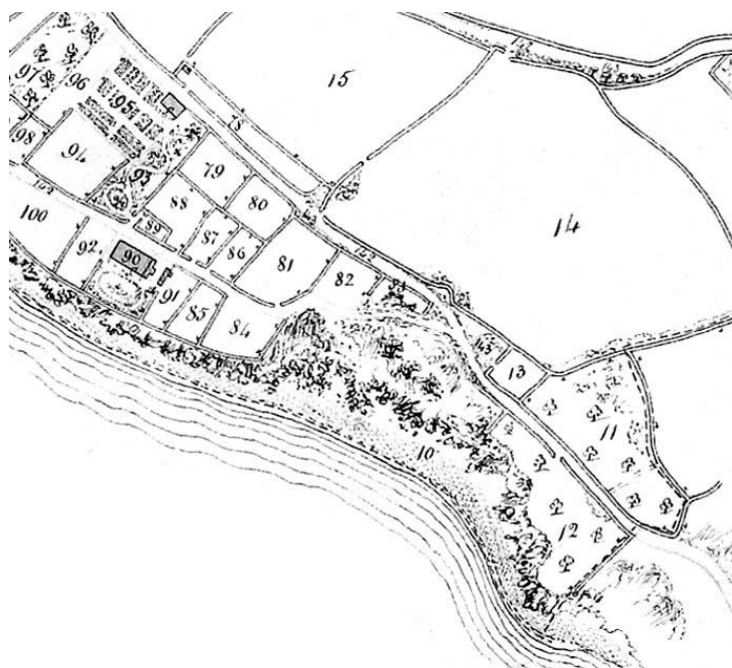

**Figure 7 Part of the Tithe Map of 1840**



leave the beach to the council. However when read the will only left personal effects to her daughter and small sums to others; no land was mentioned as the land was not hers to bequeath but held in trust.

It is interesting that the conveyance refers to the land by the numbers on the then 105 year old tithe map. The plots included are nos. 79, 80, 81, 82, 83, 84, 85, 86, 87, 88, 89 and part of 93 – see figure 7.

Also included is *that piece or parcel of land and foreshore containing together 1 acre 1 rood and 25 perches or thereabout situated in the parish of Kingswear aforesaid immediately adjoining to and on the South and East sides of the said premises hereinbefore describe.* This would be Lighthouse Beach and possibly the neighbouring Bakers Cove shown as 10 on the tithe map. This piece of property is *subject to the exceptions reservations and public right of way contained or referred to in the Conveyance dated the 11<sup>th</sup> day of August 1904 and made between Llewellyn Llewellyn and Evan Henry Llewellyn of the first part, St. John Daubeny of the second part and Home William Popham of the third part in so far as the same are still subsisting.* A copy of this 1904 conveyance has not been located.

Two years later Mrs Bankart sells most of the property to Mr Charles Fitch Northen of Rampur, Halden Road in Torquay for £7250. The plots involved are all those listed above except 85, 88, 89 but including part of 10.

After a further two years, on the 19<sup>th</sup> December 1949, Mr Northen sells plot 84 and part of 10 to Norman James Bowater OBE of Ravensbourne in Stoke Fleming for £1200. The map accompanying the conveyance, figure 8, shows that the part of plot 10 involved was the corner next to plot 84 excluding that on which the lighthouse was sited.

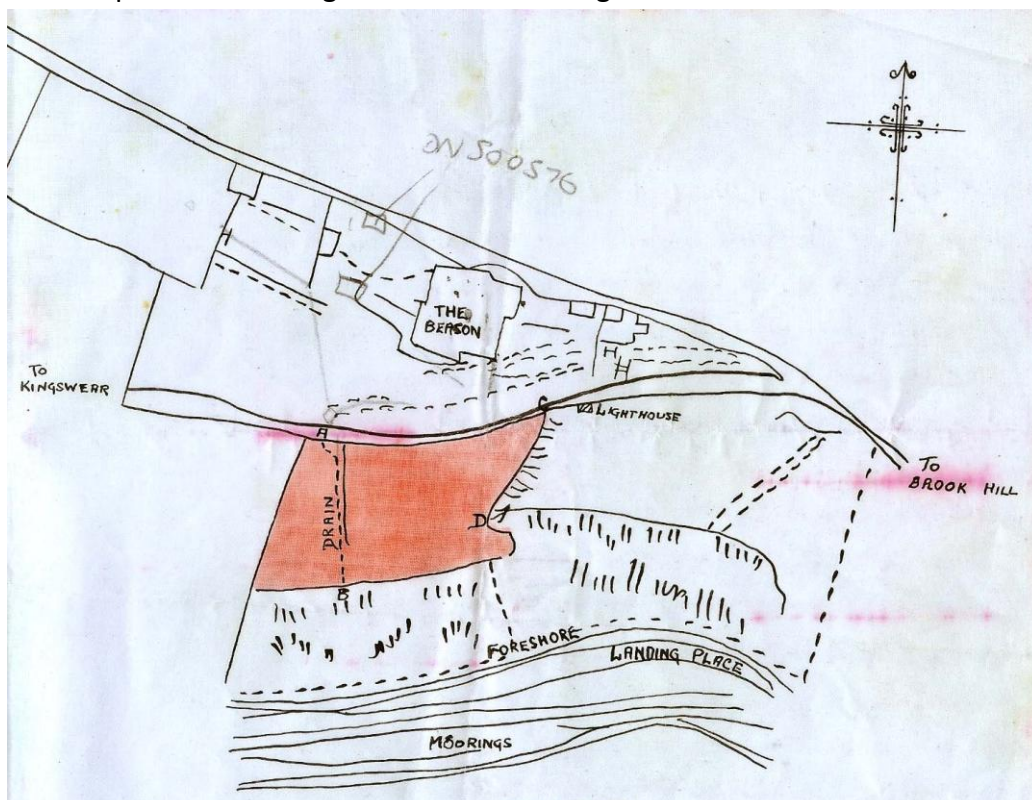

**Figure 8 Part of plot 10 sold to Mr Bowater**